

ABODO

Carefully Crafted Timber



About Abodo

Carefully Crafted Timber

Our Craft

Abodo crafts timbers with lasting beauty that are safe for people and the environment. Many exterior timbers are harvested from unsustainable old growth forests or are treated with harmful chemicals.

Our timbers stand the test of time, they are beautiful, durable and rapidly renewable.

Formed in 2001 by the Gudsell family, Abodo remains a New Zealand-owned, family business with a purpose.

Our Philosophy

Our design ethos has two core components:

Lifetime beauty

Abodo timbers are crafted to be enjoyed for years to come. Designed to age with grace, our timbers have exceptional weatherability and maintain their durability and beauty for a lifetime.

With tomorrow in mind

Our timbers are harvested from New Zealand's Forest Stewardship Council® (FSC®) certified rapidly renewable plantation forests. They are ethically crafted with respect from beginning to end – allowing us to meet today's increasing needs without disadvantaging future generations.



Vulcan Cladding



Vulcan Cladding, Architectural Series in Protector – Ebony

Overview

A renewable alternative to Western Red Cedar, Vulcan timber is verified to store more carbon than is used in its production. The thermal modification process used in its production results in a stable timber with low moisture content – meaning it won't warp, cup or bleed. This also makes Vulcan Cladding suitable for coating in dark colours, even in warm climates. Create clean lines using various profiles, including vertical shiplap and bevel back.

With a variety of coatings, finishes and profile options, Vulcan is perfect for bespoke architectural aesthetics and applications.

As the thermal modification process is preservative and chemical free, it is also safe and effective for interior applications and joinery. Vulcan is manufactured with a patented process resulting in an engineered vertical grain orientation that reduces cracking and enables stable weathering long term.

Cladding ranges: Architectural Series and Standard Series.

Wood species: Thermally Modified Radiata Pine (Pinus Radiata).

Verified to store more carbon than is used in its production, Vulcan is thermally modified for superior durability and stability.

Vulcan's range of profiles, finishes and colours can add natural texture, beauty and warmth to modern architecture, both inside and out.

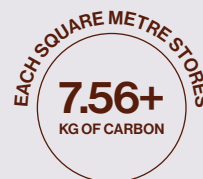

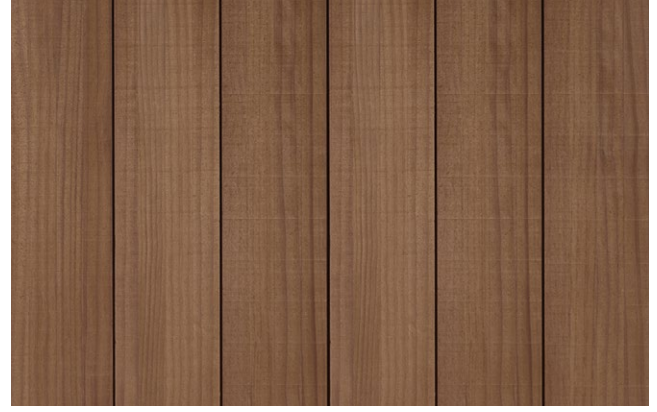

Vulcan Cladding / Architectural Series

Overview

The Architectural Series is our premium cladding, ideal for architectural projects where a largely clear aesthetic is desired. This series includes a wider range of profiles, colours and finishes.

Standard profiles:



WB10 138x20
(118mm cover) Vertical/Horizontal



WB10 180x20
(160mm cover) Vertical/Horizontal



WB12 138x20
(118mm cover) Vertical



WB12 180x20
(160mm cover) Vertical



Finline WB12F 180x20
(160mm cover) Vertical



WB12 90x20
(70mm cover) Vertical



WB12 90x40
(70mm cover) Vertical

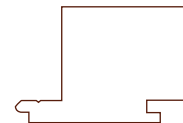

WB12 90x60
(70mm cover) Vertical



Bevelback AW62 180x20
(148mm cover) Horizontal

Profiles supplied as standard with bandsawn face. Brushed face optionally available subject to a price premium.

Lengths:

Mixed length – Supplied as packets with 1.2m and longer and/or fixed lengths at Abodo's option.

Colour:

Colours presented are in Abodo's Protector coating and are indicative only. Colour may change/fade as a part of the natural weathering process. Coating performance on brushed finish may be lower compared with bandsawn finish.



Vulcan Nero Vulcan Ebony Vulcan Graphite Vulcan Walnut Vulcan Teak Vulcan Iron Vitriol Vulcan Natural Vulcan Straw Vulcan Patina Vulcan White Vulcan Sioux (Weathered 1yr)



Vulcan Brushed Nero Vulcan Brushed Ebony Vulcan Brushed Graphite Vulcan Brushed Walnut Vulcan Brushed Teak Vulcan Brushed Iron Vitriol Vulcan Brushed Natural Vulcan Brushed Straw Vulcan Brushed Patina Vulcan Brushed White Vulcan Brushed Sioux (Weathered 1yr)



Vulcan Cladding / Standard Series

Overview

The Standard Series includes some knots and natural features, and is available in a select range of colours and profiles.

Standard profiles:



WB18 135x18mm
(115mm cover) Vertical/Horizontal
All profiles supplied with bandsawn faces.

Lengths:

Mixed length – Supplied as packets with 1.2m and longer and/or fixed lengths at Abodo's option.

Colour and finish:

Available in bandsawn finish only. Colours presented are in Abodo's Protector coating and are indicative only. Colour may change/fade as a part of the natural weathering process.



Vulcan Nero



Vulcan Ebony



Vulcan Graphite



Vulcan Walnut



Vulcan Teak



Vulcan Natural



Vulcan Straw



Vulcan Patina



Vulcan White

HOW TO CHOOSE / Architectural or Standard Series

To help you choose which timber cladding is right for you, we've created a comparison guide between Architectural and Standard Series.

Visit [abodo.co.nz/comparisonguide](https://www.abodo.co.nz/comparisonguide)

Vulcan Nexus Cladding



Vulcan Nexus Cladding (WB10 Profile 180x20) in Protector – Graphite

Overview

Abodo Vulcan Nexus Cladding is one of our premium weatherboard timbers. Created from Abodo's thermally modified New Zealand plantation timber for superior beauty, durability and weathering characteristics.

Vulcan Nexus Cladding is manufactured using finger jointed timber to create cladding in long lengths with a unique visual aesthetic. One universal profile allows for secret fixing in a vertical or horizontal orientation.

Vulcan Nexus Cladding is suitable for coating in darker colours, and is a renewable alternative to Western Red Cedar timber cladding.

Wood species: Thermally Modified Radiata Pine (Pinus Radiata).

Standard profiles:



WB10 180x20
(160mm cover) Vertical/Horizontal

Lengths:

6.1m*

*Up to 10% of an order may include mixed lengths 1.2m and longer at Abodo's option.

Colour and finish:

Available in bandsawn finish only. Colours presented are in Abodo's Protector coating and are indicative only. Colour may change/fade as a part of the natural weathering process. Darker tones will hide the finger joint better than lighter tones that will tend to show up more after weathering.



Vulcan Nero



Vulcan Ebony



Vulcan Graphite



Vulcan Walnut



Vulcan Teak



Vulcan Iron Vitriol



Vulcan Natural



Vulcan Straw



Vulcan Patina



Vulcan White

Vulcan Primed Cladding



Vulcan Primed Cladding (AW62P Profile 187x18)

Overview

Vulcan Primed Cladding is created from thermally modified New Zealand plantation timber and factory pre-primed for optimal coating performance. The chemical-free thermal modification process enhances stability and reduces resin content so is good for dark colours. Available in the innovative WB10 secret fix system, no punching and puttying of face fixings is required. Achieving superior performance in service while reducing installation time, Abodo cladding systems are CodeMark certified.

Wood species: Thermally Modified Radiata Pine (Pinus Radiata).

Standard profiles:



WB10P 135x18
(115mm cover) Stocked profile.
Order subject to minimum order quantity and lead time.



WB10P 180x18
(160mm cover) Horizontal/Vertical. Stocked profile.



WB10FP 180x18
(160mm cover) Horizontal/Vertical. Supplied as a custom profile.
Order subject to minimum order quantity and lead time.



AW62P 187x18
(155mm cover) Supplied as a custom profile.
Order subject to minimum order quantity and lead time.

Lengths: 6.1m finger jointed – up to 10% of an order may be supplied mixed length 1.2m and longer.

*Up to 10% of an order may include mixed lengths 1.2m and longer at Abodo's option.

Colour: Vulcan Primed Cladding is factory pre-primed for paint finish.



Vulcan Primed

Tundra Cladding



Tundra Cladding (AW702 Profile 140x20) Bandsawn Finish in Iron Vitriol

Overview

Tundra is created from New Zealand plantation Douglas Fir heart wood.

With rustic timber features and defects, Tundra Cladding is an excellent natural choice. A fine sawn face allows a depth of grain, and optimal coating performance.

Tundra Cladding is naturally durable so does not require any chemical preservatives.

When specified and installed in accordance with the manufacturers instructions, Tundra Cladding systems will achieve CodeMark status for guaranteed acceptance with New Zealand building consent authorities.

Tundra is a rustic product that may experience some surface cracking and board movement as part of the natural weathering process.

Wood species: Douglas Fir Heart.

Standard profiles:

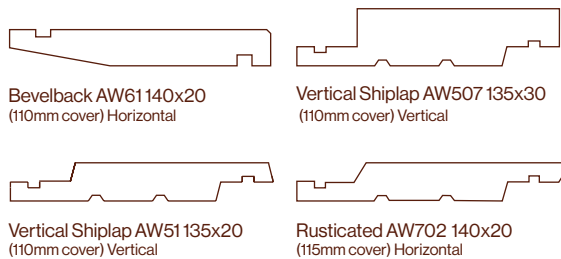

Profiles supplied as standard with bandsawn face. Brushed face optionally available subject to a price premium.

Lengths: Mixed length – Supplied as packets with 1.8m and longer, or fixed lengths at Abodo's option.
Fixed length – 4.8, 5.4, 6.0m (subject to availability).

Product supplied as standard in mixed length. Specified fixed length orders may be available but are subject to conditions including 150LM minimum quantity per length/profile, price premium and availability. Please check with Abodo prior to placement of order.

Colour and finish:

Fine bandsawn face. Brushed finish available optionally on request. Colours presented are in Abodo's Protector coating and are indicative only. Colour may change/fade as a part of the natural weathering process. Coating performance on brushed finish may be lower compared with bandsawn finish.



Tundra Graphite



Tundra Walnut

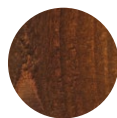

Tundra Teak



Tundra Iron Vitriol



Tundra Natural



Tundra Straw



Tundra Patina

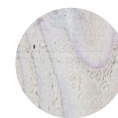

Tundra White



Tundra Sioo:x
(Weathered 1yr)



Tundra Brushed
(Available in all above colours)

Vulcan Shingles

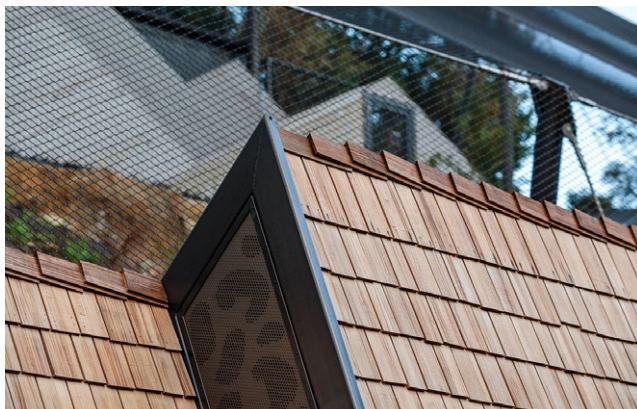

Vulcan Shingles, Uncoated

Overview

Abodo Vulcan Shingles are created using Vulcan timber, resulting in a product with all the beauty, durability and stability of this thermally modified eco-timber.

Delivering all the charm of yesteryear, updated for ease of use in modern applications, Abodo Vulcan Shingles are a durable, high-end architectural finish for roofs, walls and gable ends.

The durability of the product is furthered by a low-VOC, water-based OPX preservative treatment that guards against mould and insects. It is also lightweight, making it easy to install and maintain. The beautiful homogenous brown colour will silver off with exposure to weather if left uncoated.

Wood species: Thermally Modified Radiata Pine (Pinus Radiata).

Standard profiles: Width: 90mm and 120mm – supplied as mixed width with a minimum ratio of 70:30.
Thickness: 12mm/6mm tapered
Length: 450mm.



450x90



450x120



12mm/6mm tapered

Coverage:

Application	Pitch ¹	Exposure ²	Approximate coverage pcs/m ²		Approximate weight kg/m ²
			90mm	120mm	
Wall	90°	200mm	53	40	5.4
Roofing	>18°	140mm	76	58	7.7

Notes:

¹ Pitch = slope of the wall/roof.

² Exposure = the section of shingle left exposed to the weather after fixing.

³ Coverage rates above are indicative only and do not include allowance for on-site wastage, starter course, valleys and capping. More accurate quantities should be confirmed prior to order.

Colour:

Vulcan Shingles is supplied as standard uncoated.



Vulcan Uncoated

Vulcan Screening

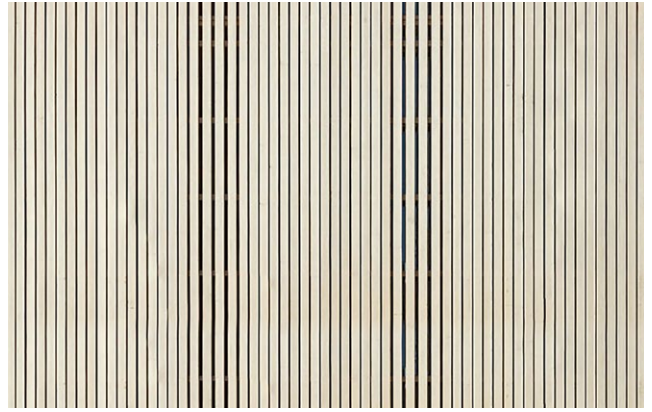

Vulcan Screening (65x25) in Sioo:x Wood Coating

Overview

Vulcan Screening is created from thermally modified New Zealand plantation timber and engineered with a vertical grain construction for superior weathering characteristics.

The thermal modification process combined with lamination means Vulcan Screening has enhanced stability, reduced resin content, is a beautiful homogenous brown colour, and is naturally durable so does not require any chemical preservatives.

An excellent choice for appearance grade applications such as joinery, pergola, screening, facade fins.

Wood species: Thermally Modified Radiata Pine (Pinus Radiata).

Lengths: Mixed length – Supplied as packets with 1.8m and longer, or fixed lengths at Abodo's option.
Fixed length – 3.6, 4.2, 4.8, 5.4m (subject to availability) at time of processing.

Product supplied as standard in mixed length. Specified fixed length orders may be available but are subject to conditions including 150LM minimum quantity per length/profile, price premium and availability. Please check with Abodo prior to placement of order.

Sizes:

Finished dimensions Boards (mm)	Finished dimensions Beams (mm)	Finished dimensions Posts (mm)
42x18	65x42	42x42
65x18	88x42	65x65
88x18	138x42	88x88
120x18	180x42	138x138
138x18	88x65	180x180
180x18	138x65	
42x25	180x65	
65x25	138x88	
88x25	180x88	
138x25		
180x25		
238x25		
65x32		
88x32		
138x32		
180x32		
290x32		

Supplied as standard with fine bandsawn finish four sides. Standard sizes: 42x42, 42/65/88/120/138/180x42/18, 88x88, 65x88, 138x138.

Note: Sizes in **bold** are standard sizes.

Other sizes are subject to minimum order volumes and lead time.

Custom laminated sizes >180mm width are subject to prior approval by Abodo, minimum order volumes and lead time.

Colour and finish: Available in bandsawn finish only. Colours presented are in Abodo's Protector coating and are indicative only. Colour may change/fade as a part of the natural weathering process.



Vulcan Nero Vulcan Ebony Vulcan Graphite Vulcan Walnut Vulcan Teak Vulcan Iron Vitriol Vulcan Natural Vulcan Straw Vulcan Patina Vulcan White Vulcan Sioo:x (Weathered 1yr)

Vulcan Panelling



Vulcan Panelling (V-Groove TG9 Profile) in Protector – Straw

Overview

Vulcan Panelling is created from thermally modified New Zealand plantation timber and engineered with a patented vertical grain construction for superior weathering characteristics.

The thermal modification process and vertical grain structure means Vulcan Panelling has enhanced stability, reduced resin content, is a beautiful homogeneous brown colour, and is naturally durable so does not require any chemical preservatives. An excellent choice for internal ceilings, walls and exterior soffits.

Wood species: Thermally Modified Radiata Pine (Pinus Radiata).

Standard profiles:



TG9 135x10



TG9 175x10



TG17 84x17

Profiles supplied as standard with smooth face. Brushed face optionally available subject to a price premium. Smooth face requires sanding prior to coating. Please contact Abodo for recommended coating options.

Lengths: Mixed length – Supplied as packets with 1.2m and longer, or fixed lengths at Abodo's option.

Product supplied as standard in mixed length. Specified fixed length orders may be available but are subject to conditions including 150LM minimum quantity per length/profile, price premium and availability. Please check with Abodo prior to placement of order.

Colour and finish:

Vulcan Panelling is supplied as standard uncoated.



Vulcan Uncoated



Vulcan Brushed Uncoated

Vulcan Joinery – Vertical Grain



Vulcan Joinery – Vertical Grain

Overview

Vulcan Joinery is created from thermally modified New Zealand plantation timber and engineered with a vertical grain construction for superior weathering characteristics.

The thermal modification process combined with lamination means Vulcan Joinery has enhanced stability, reduced resin content, is a beautiful uniform brown colour, and is naturally durable so does not require any chemical preservatives.

An excellent choice for windows, doors and interior joinery in both paint and stain finish (internal only).

Wood species: Thermally Modified Radiata Pine (Pinus Radiata).

Sizes: Standard stock laminated block sizes
Available in pack lots only

Approx only (mm)

146x142

146x147

146x183

146x199

Dimensions and construction may vary.
Some stepping up to 4mm depth and glue run-off may be present in the glue line edges of laminated blocks.
Custom laminated sizes >199mm height are subject to prior approval by Abodo, minimum order volume and lead time.

Lengths: Length availability varies and is subject to availability. Our main volume length is 4.2m. Other lengths 3.6, 4.8m may be possible on special order subject to availability.

*Specified fixed lengths may be available but are subject to conditions including minimum quantity of 1 packet per length, price premium and availability. Please check with Abodo prior to placement of order.

Colour and finish: Some stepping up to 4mm depth and glue run-off may be present in the glue line edges of laminated blocks. Supplied as standard uncoated.



Vulcan Uncoated

Substrate colour: Chocolate brown. (Timber will weather to grey unless a pigmented coating is applied and maintained).

Coating: Vulcan will take most stains, penetrating oils and paints well, though up-take of coating is generally higher than normal.

Vulcan Decking

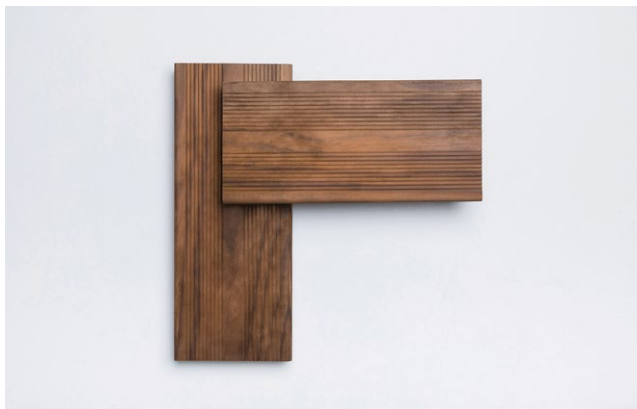

Vulcan Decking (DK16V Profile 142x27), Uncoated

Overview Vulcan Decking is created from thermally modified New Zealand plantation timber and then treated with an organic preservative system that includes a water repellent for superior durability.

The thermal modification process means Vulcan Decking has enhanced stability, reduced resin content and is a beautiful homogeneous brown colour.

Wood species: Thermally Modified Radiata Pine (Pinus Radiata).

Profiles: Graded to the reeded face.



DK16V 142x27

Installation with reeded face up only.

Sizes: Width x thickness (mm)
142x27mm.

Lengths: Mixed length – Supplied as packets with 1.8m and longer, or fixed lengths at Abodo's option.
Fixed length – 3.0, 3.6, 4.2, 4.8, 5.4m (subject to availability).

Colour:



Vulcan Uncoated

Coating: Product is supplied uncoated as standard. Available factory finished with Protector – Clear or Sioo:x subject to 225lm minimum order volume.

Vulcan Smooth Decking



Vulcan Smooth Decking (DK4R Profile 140x27), Uncoated

Overview Vulcan Smooth Decking is created from thermally modified New Zealand plantation timber and then treated with an organic preservative system that includes a water repellent for superior durability.

The thermal modification process and predominantly vertical grain orientation means Vulcan Smooth Decking has enhanced stability, reduced resin content and is a beautiful homogeneous brown colour.

Wood species: Thermally Modified Radiata Pine (Pinus Radiata).

Profiles: Graded to one face.



DK4R 140x27

Sizes: Width x thickness (mm)
140x27mm.

Lengths: Mixed length – Supplied as packets with 1.8m and longer, or fixed lengths at Abodo's option.
Fixed length – 3.0, 3.6, 4.2, 4.8, 5.4m (subject to availability).

Colour:



Vulcan Uncoated

Coating: Chocolate brown (timber will weather to grey unless a pigmented coating is applied and maintained).
Clear coating penetrating finishes are recommended, allowing the timber to silver off naturally. Dark pigmented finishes may be subject to wear marks and higher maintenance.

Sand Decking



Sand Decking (DK14S Profile 115x21) in Protector – Pearl

Overview

Abodo Sand is our premium eco-timber decking product, and features vertical grain for natural stability and long term appearance. Sand Decking is a genuine eco alternative to hardwood decking with a silky smooth finish. A smooth face highlights the distinctive grain, and is easy to clean.

Wood species: Radiata Pine (Pinus Radiata).

Profiles: Graded to the smooth face.



DK14S 90x21

Sizes: Width x thickness (mm)
90x21mm.

Lengths: Mixed length – Supplied as packets with 1.8m and longer, or fixed lengths at Abodo's option.

Colour: Colours are indicative only and may change/fade with exposure to the weather.



Sand Pearl

Sand Teak

Cladding

Indicative Quantities Chart

Profile	Width	Depth	Orientation	Cover (mm)	Cavity batten Centres (mm)	Fixings (Pieces/ lm)	Fixings (Pieces/ m ²)	Lineal metres/ m ²	Protector Second Coat Litres/lm*	Protector Second Coat Litres/m ² *
Vulcan Cladding, Architectural Series – Clear Grade – Stain Finish										
Vulcan WB10	138 x 20		Horizontal	118	600	1.67	14.15	8.47	0.0125	0.100
Vulcan WB10	180 x 20		Horizontal	160	600	1.67	10.42	6.25	0.0160	0.100
Vulcan AW62	180 x 20		Horizontal	148	600	1.67	11.26	6.76	0.0148	0.100
Vulcan WB10	138 x 20		Vertical	118	480	2.08	17.62	8.47	0.0125	0.100
Vulcan WB10	180 x 20		Vertical	160	480	2.08	13.02	6.25	0.0160	0.100
Vulcan WB12	138 x 20		Vertical	118	480	2.08	17.66	8.47	0.0118	0.100
Vulcan WB12/WB12F	180 x 20		Vertical	160	480	2.08	13.02	6.25	0.0160	0.100
Vulcan WB12	90 x 20		Vertical	70	480	2.08	29.76	14.29	0.0070	0.100
Vulcan WB12	90 x 40		Vertical	70	480	2.08	29.76	14.29	0.0070	0.100
Vulcan WB12	90 x 60		Vertical	70	480	2.08	29.76	14.29	0.0070	0.100
Vulcan Cladding, Standard Series – Light Feature Grade – Stain Finish										
Vulcan WB18	135 x 18		Horizontal	115	600	1.67	14.49	8.70	0.0125	0.100
Vulcan WB18	135 x 18		Vertical	115	480	2.08	18.12	8.70	0.0125	0.100
Vulcan Primed Cladding – Smooth Face – Clear Grade – Pre-Primed										
Vulcan Primed WB10P	135 x 18		Horizontal	115	600	1.67	14.49	8.70	N/A	N/A
Vulcan Primed WB10P	180 x 18		Horizontal	160	600	1.67	10.42	6.25	N/A	N/A
Vulcan Primed AW62P	187 x 18		Horizontal	155	600	1.67	10.75	6.45	N/A	N/A
Vulcan Primed WB10P	135 x 18		Vertical	115	480	2.08	18.12	8.70	N/A	N/A
Vulcan Primed WB10P	180 x 18		Vertical	160	480	2.08	13.02	6.25	N/A	N/A
Tundra Douglas Fir Cladding – Standard Grade – Stain Finish										
Tundra AW702	140 x 20		Horizontal	115	600	1.67	14.49	8.70	0.0115	0.100
Tundra AW61	140 x 20		Horizontal	108	600	1.67	15.43	9.26	0.0108	0.100
Tundra AW51	135 x 20		Vertical	110	480	2.08	18.94	9.09	0.0110	0.100
Tundra AW507	135 x 30		Vertical	110	480	2.08	18.94	9.09	0.0110	0.100

Clarifications:

- Quantities given do not allow for wastage or additional fasteners needed for detailing/mouldings.
- Final order quantities are the buyer's responsibility and should be checked and verified prior to order placement.
- Abodo will not accept liability for over or under-ordered items.
- In general allow approx 10-15% additional to above for wastage.

* Coating quantities are approximate only and may vary depending on application method and rate.



CodeMark

CMNZ70046



The mark of responsible forestry
FSC® C010962

Accessories

Standard exterior mouldings:

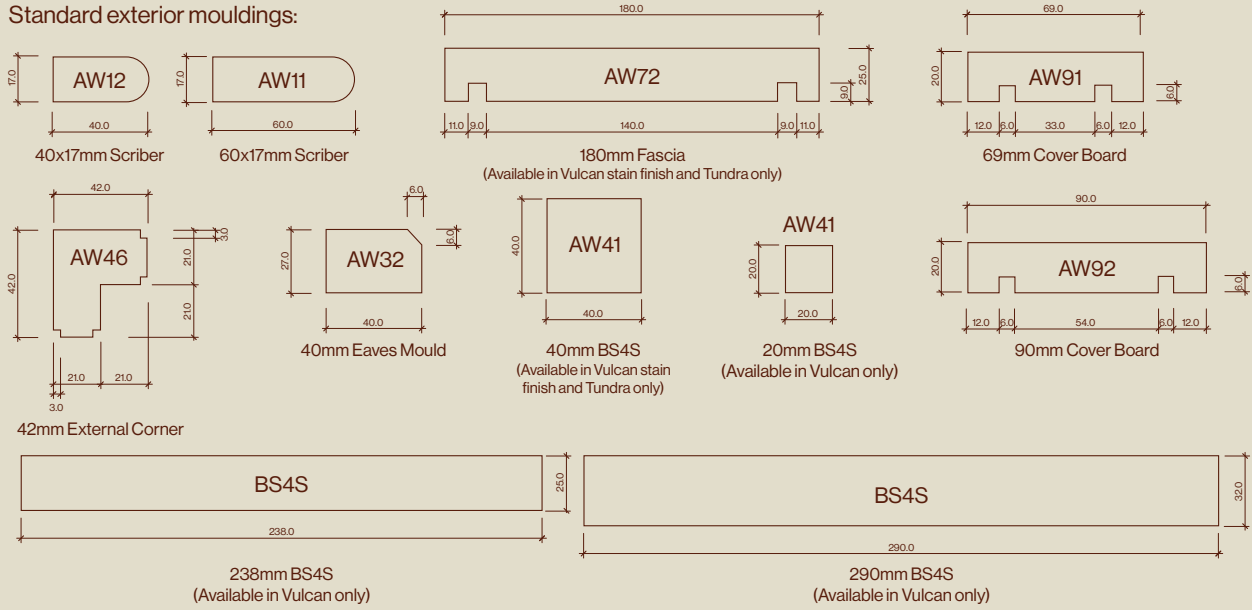

Mouldings generally supplied in 4.2m lengths unless advised otherwise. Primed profiles supplied with 2mm radius to top edges.

Horizontal castellated cavity battens:

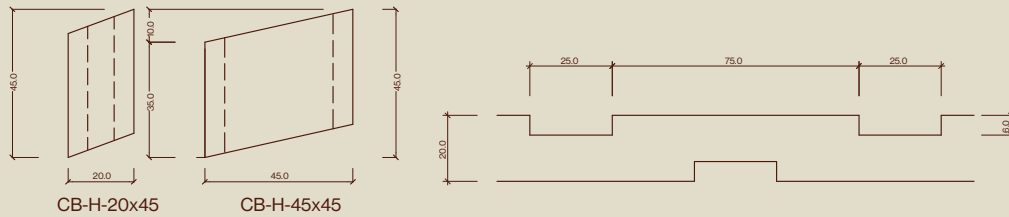

Flashings:

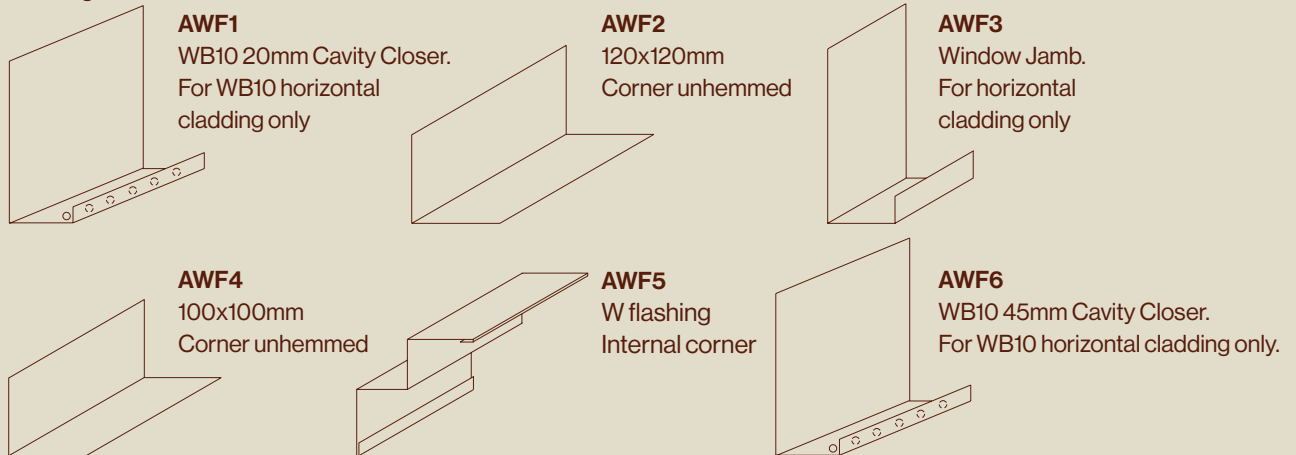

Supplied as 3m length stainless steel. Alternative flashings such as PVC may be used in conformance with E2 and Abodo details.

Fixings and Coatings:

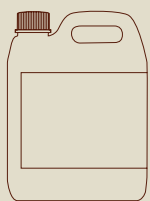

Protector
500ml, 4L, 10L

Protector – End Seal
1L bottle

Protector – Hybrid
4L, 10L

Char Oil
4L, 10L

Sioo:x
Step 1 or Step 2, 5L

Sioo:x Maintenance Wash
5L

Sioo:x End Grain Sealer
1L

Sioo:x Pre-Wash
1L

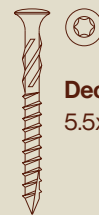

Decking Screw
5.5x60mm



Cladding Screw
4x45mm, 4.5x65mm
(4x45mm suitable for use with structurally fixed cavity batten only)