

1. Weatherboards must be coated with at least one coat all sides prior to fixing.
2. Fixing points must be pre-drilled minimum 1mm smaller than the fastener.
3. Cut ends and exposed timber must be sealed with an approved coating or end seal.

Internal wall lining

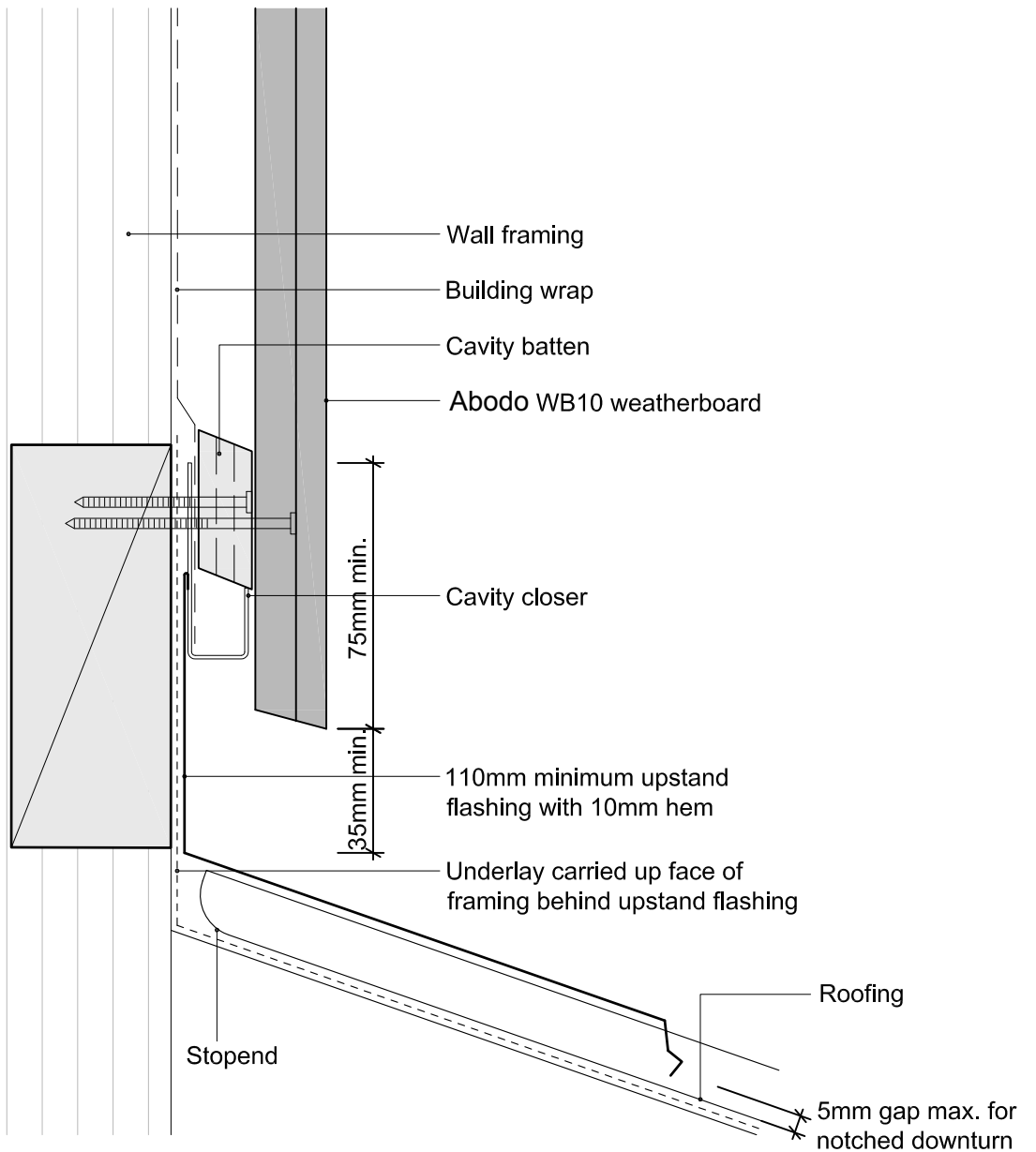

Note: refer to NZBC E2/AS1 Table 7 for apron flashing cover over roofing



CODEMARK™

CMA-CM40070

Hector WB10 Vertical Weatherboard

Apron Flashing

Scale

1:2

Date

09/12/14



© 2013 Abodo Wood Ltd, PO Box 8961, Symonds St, Auckland 1052
 Ph 64 9) 302 9555 Fx 64 9) 302 9550
www.abodo.co.nz

Drawing No.

HV.C.F.57