

## Sand Screening



26x68 Rhombus Smooth

### Overview

A unique and versatile timber screening profile, Sand Screening can also make an attractive facade or fence. Designed to allow airflow, but provide privacy Sand Screening is a quirky and original timber screening solution.

Wood species: Radiata Pine (Pinus Radiata).

Standard Profile:



RHB 26x68

Quality: **Select Grade**/Face and edges virtually free of any defects (one edge knot and one small face defect allowed per piece in 20% of boards only), back face allows some isolated defects.

Moisture content: Kiln Dried, max. 14% MC (+/-2%).

Sizes: Thickness x width (mm)  
26mm x 68mm.

Lengths: 2.4 - 4.8m\*

\*Product is supplied as standard in 'random length' or otherwise lengths at Abodo's option. Specified fixed lengths may be available but are subject to conditions including minimum quantity, price premium and availability. Please check with Abodo prior to placement of order.

### Product specifications

Treatment: Treated with ACQ (Celcure AC-500) non chrome and non arsenic preservation system - with 100% sapwood penetration.  
Durability class 1 after treatment (EN113); Class 3 (EN14915), H3 (AS1604) or H3.2 (NZS3640).  
Suitable for exterior above-ground applications.

Coating: Supplied raw as standard or with optional 2 coats of factory-applied of Abodo Protector penetrating wood oil.

Construction: Solid timber.

Finishing: Smooth dressed.

Density: 450-480kg/m<sup>3</sup>.

Hardness: Medium-low (3.5kN Janka).

## Sand Screening

### Product specifications

Workability:	Excellent - cutting, gluing - easy fix no pre-drilling required.
Guarantee:	30 years against rot, fungal decay and termite attack – conditions apply.
Certification:	FSC-certified mixed, No.: SGS-COC-004944.

### Fixing overview

- Always wear dust mask and eye protection when working timber.
- Structurally fix min. 45x45mm H3.2 treated timber cavity battens to substrate with min 8gx75mm stainless steel screws off-set along the centre line at max 600mm centres.
- Horizontal cavity battens must be beveled at 10 degrees to allow water drainage away from the cavity.
- Cavity battens spaced at maximum 600mm centres.
- Fix boards horizontally or vertically with one screw through the face at each batten using stainless steel screws to achieve minimum 30mm penetration into the batten or substrate.
- Ensure 6-10mm gap between boards.
- Join butt ends over battens only with one screw per edge, leaving 2mm gap.
- Apply 2 coats of Abodo Protector penetrating wood oil to the timber for superior performance in service.

### Fixing details:

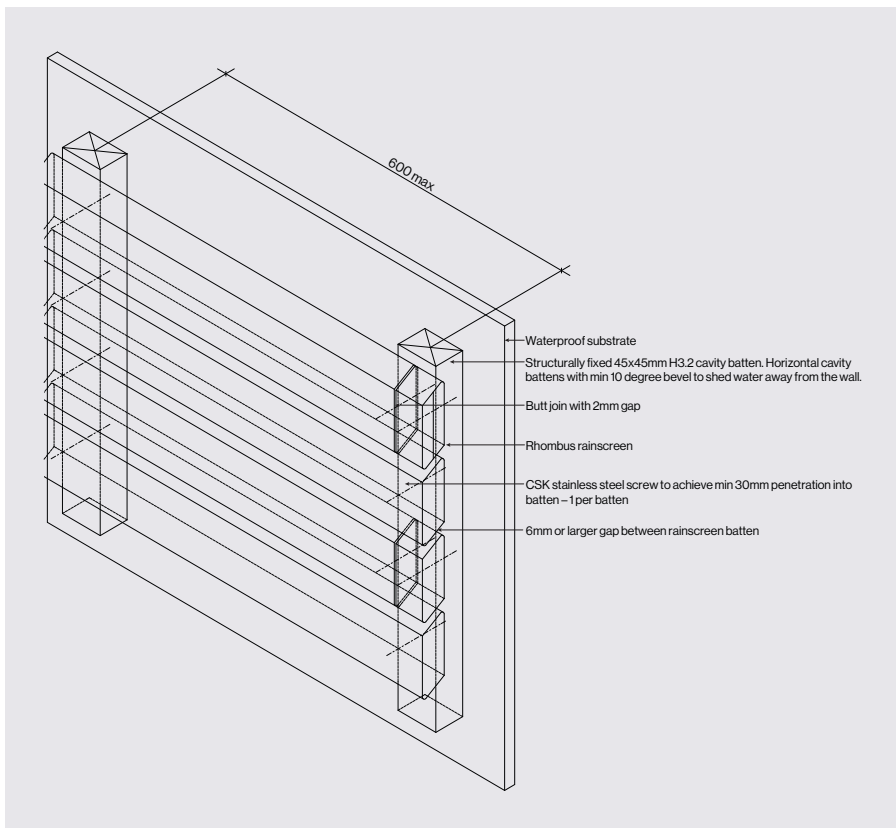

## Sand Screening

### Maintenance

- Wash down regularly with gentle detergent, warm water and soft brush.
- Mould growth can occur on timber, especially in high humidity conditions. For heavily stained areas use Abodo Rejuvenator or similar oxygenating cleaner, then apply similar mould inhibitor.
- Apply new coats of paint or stain periodically as per manufacturers' recommendations.
- Weathering of uncoated timber will result in colour change to a silver grey (known as 'silvering'), this is due to loosening of timber fibres and a gradual wearing away of the surface due to intermittent exposure to UV and rainfall.
- Unprotected timber will swell and shrink as moisture is absorbed and lost- over time this may lead to small cracks forming in the surface (also known as 'surface checking') or possibly cupping of some boards.

### Accessories

Abodo Protector – Water Borne 4L, 10L:



Abodo Stainless Steel Screw 5.5x60mm:

